

South Humber Bank Energy Centre Project

Planning Inspectorate Reference: EN010107

South Marsh Road, Stallingborough, DN41 8BZ

The South Humber Bank Energy Centre Order

Document Reference: 4.8 Indicative Towns Water Connection Plan

The Infrastructure Planning (Applications: Prescribed Forms and Procedure) Regulations 2009 - Regulation 5(2)(o)



Applicant: EP Waste Management Ltd
Date: April 2020

DOCUMENT HISTORY

Document Ref	4.8 Indicative Towns Water Connection Plan		
Revision	1.0		
Author	AO		
Signed	AO	Date	April 2020
Approved By	RO		
Signed	RO	Date	April 2020
Document Owner	Fichtner Consulting Engineers		

- KEY**
- THE ORDER LIMITS
 - - - TOWNS WATER PIPEWORK INDICATIVE ROUTE

NOTE
 Infrastructure Planning
 (Applications: Prescribed Forms and Procedure)
 Regulations 2009 - Regulation 5(2)(c)

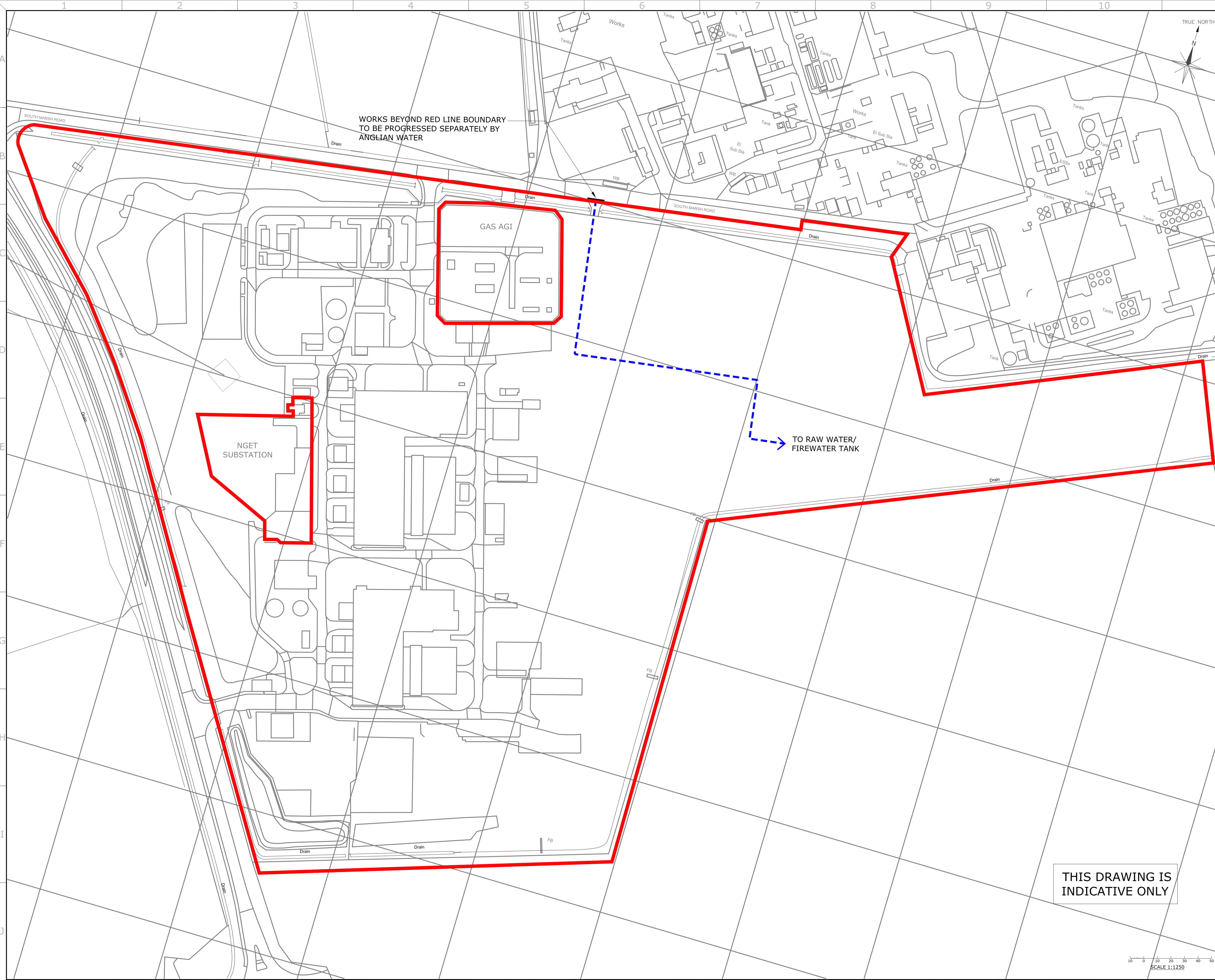
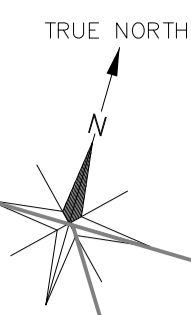

WORKS BEYOND RED LINE BOUNDARY
 TO BE PROGRESSED SEPARATELY BY
 ANGLIAN WATER

GAS AGI

NGET
 SUBSTATION

TO RAW WATER/
 FIREWATER TANK

THIS DRAWING IS
 INDICATIVE ONLY

1.0	FOR APPROVAL	AO	RO	08.04.20
REV.	DETAILS OF REVISION	DRAWN	CHKD	APR

FICHTNER
 CONSULTING ENGINEERS LIMITED
 Kingsgate, Wellington Road North,
 Stockport, Cheshire, SK4 1LW, UK
 Tel: 0161 476 0032
 Website: www.fichtner.co.uk

CLIENT: EP WASTE MANAGEMENT LTD
 SITE: SOUTH HUMBER BANK
 PROJECT: SOUTH HUMBER BANK ENERGY CENTRE
 TITLE: SOUTH HUMBER BANK ENERGY CENTRE ORDER INDICATIVE TOWNS WATER CONNECTION PLAN

DRAWING STATUS:		FOR APPROVAL	
DRAWN BY:	AO	DATE:	08.04.20
CHECKED BY:	RO	DATE:	08.04.20
APPROVED BY:		DATE:	
FILENAME:	S2522-0610-0010 1.0 DTW DCI Indicative Towns Water Connection Plan		
OFFICE OF ISSUE:	STOCKPORT		
SHEET SIZE:	A1	SCALE:	1:1250
DRAWING No.:	S2522-0610-0010		REVISION:

SCALE 1:1250